



Cellink4G+
Cellphone Entry Module
User Manual
Rev. D

**FOR VEHICLE GATE
SYSTEMS USE ONLY**

Platinum Access Systems Inc.

CONTENTS

- **GENERAL DESCRIPTIONS**
- **INSTALLATIONS**
- **USER STRUCTURE**
- **MODULE CONFIGURATIONS**
- **GATE OPERATIONS**
- **HOLD OPEN SCHEDULE OPERATIONS**
- **CLOUD PROGRAMMING OPERATIONS**

GENERAL DESCRIPTIONS

Cellink4G+ is a 4G LTE gate access control module, which works with carrier **T-Mobile**. It supports 2000 phone users and over 4000 history logs, and provides a fully remote gate access control via smartphone App.

With Platinum cloud remote access, **Cellink4G+** module is an ideal replacement of existing light commercial entry access control units. Its phone users, hold open schedules, permission schedules and history logs can be accessed on a webpage based environment from any network enabled device around the world.

Platinum Access App features:

- Set master and super users.
- Add, check, search and delete phone users.
- Open gate.
- Hold open and release gate hold open.
- Set, check and clear hold open schedules.
- Monitor gate status.
- Set and check internal real time clock.
- Set control relay strike delay.
- Control the secondary contact output.
- Enable cloud connection.
- Remove cloud account.

INSTALLATIONS

1. SIM Card

This module accepts standard size SIM card. If only a micro or nano SIM card is available, SIM card adapters as below are required.



Fig. 1 SIM Card Adapters

Open the module case and install the SIM card as shown in Fig 2.

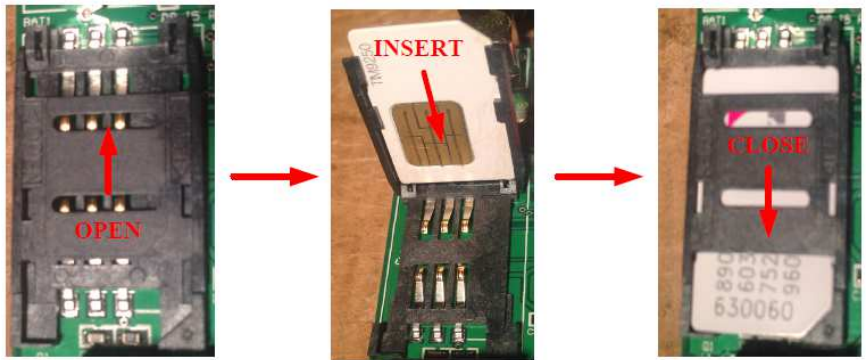

Fig. 2 SIM Card Installation

2. Module

As shown in Fig. 3, mount the module inside gate operator protection case or control box.

Note: The module is not designed to work outside operator enclosure in outdoor environment.

3. Antenna

There are 2 types of antennas, whip (default) and dome, working with the module. As shown in Fig. 3, attach and mount the antenna respectively.

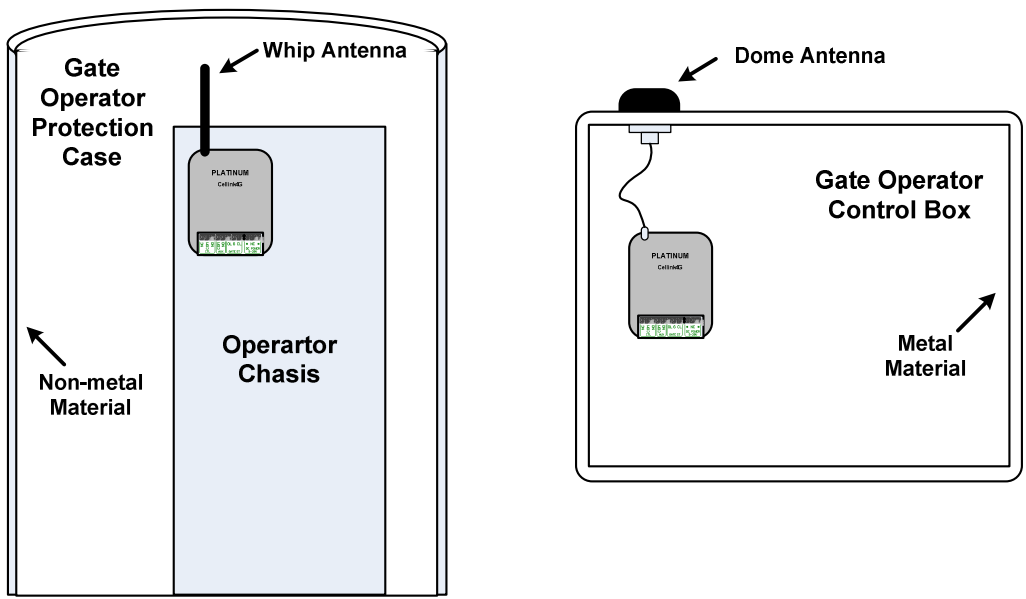

Fig.3 Antenna Installation

4. Wiring

Fig. 4 shows the wiring from module to operator.

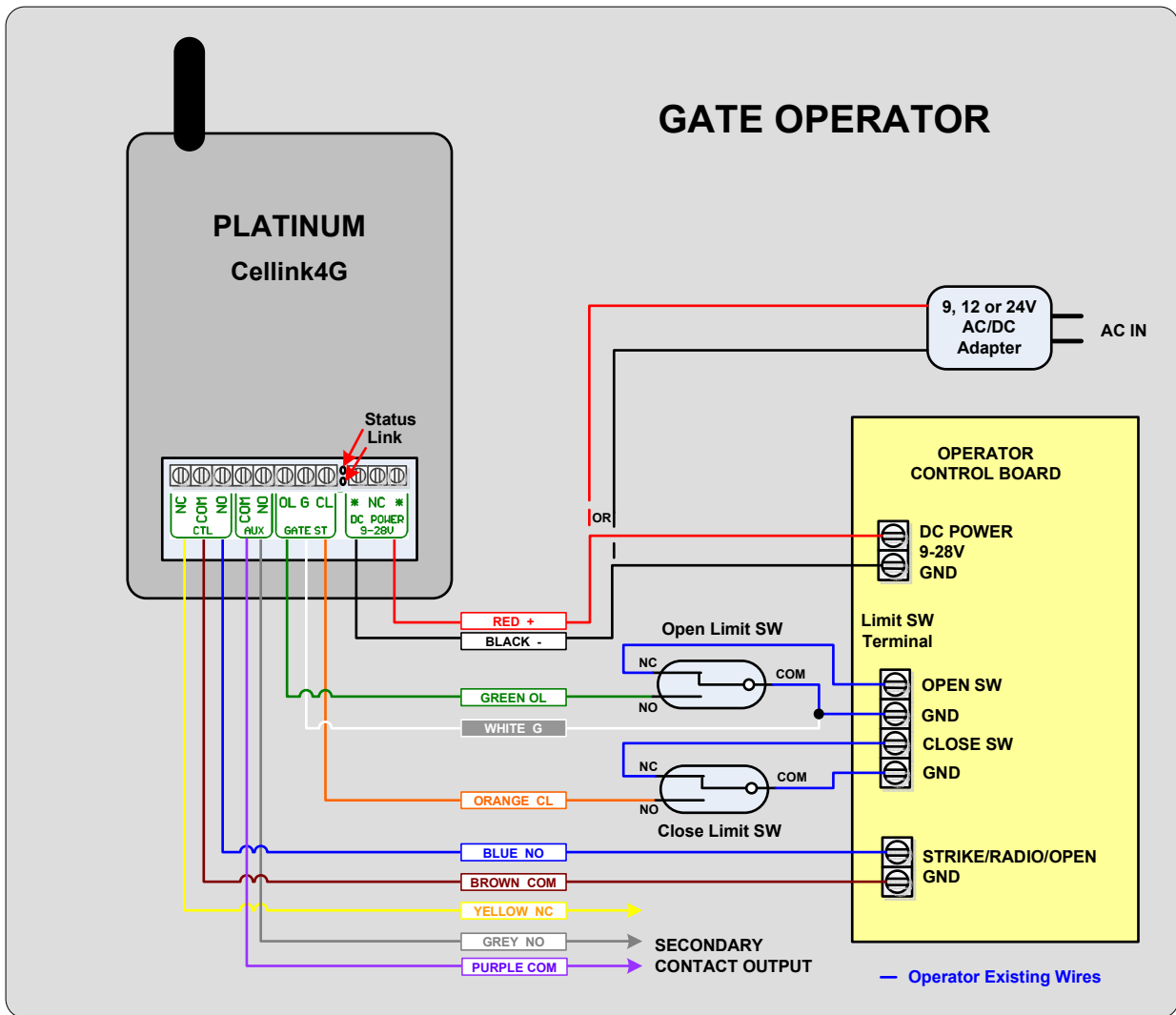

Fig. 4 Wiring Diagram

Note:

- a. **When operator DC power is used, an external DC/DC adaptor is required if the DC power is noisy.**
- b. The limit switch wiring is to monitor gate status. It is optional.
- c. Pulse counting limits are not working with the gate status monitoring function.
- d. Before wiring to the gate operator limit switches, verify the limit switch COM terminals are connected to the control board GND. If not, refer to the operator installation manual and re-wire limit switch COM and NC terminals.

5. Power Up

When the module is turned on, it will reboot and scan for local GSM network. Once the module is registered to the network, both orange “STATUS” light and blue “LINK” light will flash.

USER STRUCTURE

For security purpose, the users are classified into 3 levels, **Master User**, **Super Users** and **Normal Users**. The privileges for each user level are shown below:

Functions	Master (1 User)	Super User (≤8 Users)	Normal User (≤2000 Users)
Enter Cell Module Phone #	√	√	√
Set Master User Functions:			
Set Master User	Any phone can be set as Master User, if no Master User has been set in the unit.		
Remove Master User	√	X	X
Operation Functions:			
Open	√	√	√
Hold Open	√	√	X
Hold Open Release	√	√	X
Schedule Functions:			
Set Single Schedule	√	√	X
Set Weekly Schedule	√	√	X
Check Single Schedule	√	√	X
Check Weekly Schedule	√	√	X
Clear Single Schedule	√	√	X
Clear Weekly Schedule	√	√	X
Setting Functions:			
Add Super User Phone #	√	X	X
Delete Super User Phone #	√	X	X
Check Master/Super Phone #	√	√	X
Set Date & Time	√	√	X
Check Time	√	√	X
Check Gate Status	√	√	X
Control AUX Output	√	√	X
Add User Phone #	√	√	X
Delete User Phone #	√	√	X
Search User Phone #	√	√	X
Set Relay Delay	√	√	X

Reset Camera	N/A	N/A	N/A
Add Temporary Key Code	N/A	N/A	N/A
Delete Temporary Key Code	N/A	N/A	N/A
Add Permanent Key Code	N/A	N/A	N/A
Enable Cloud	√	X	X
Reconnect Cloud	√	X	X
Remove Cloud Account	√	X	X
Service	Platinum Customer Service Use Only		
About	√	√	√

Table1. Users and Functions

MODULE CONFIGURATIONS

1. Download Smartphone App

Search and download “**Platinum Access**” App from **Apple Store** for iPhones, or from **Amonzon App Store** for Android phones. Install the App and ensure the icon below is presented on the phone home screen.



Access

Note: Android App can also be downloaded from www.platinumasi.com on “**Cellink4G+**” product page.

2. Configure Module via App

On cellphone, launch the App, select one of the items, follow the onscreen instruction to enter data (if needed) and press “**SEND**” on text message screen to send the configuration commands. After the operation is performed, the module will reply the sender with an acknowledgement text message.

!! WARNING
All text messages automatically generated by the App are not allowed to edit. Just press “SEND” to deliver the original message.

All following configurations are under App “**Settings**” tab.

1) Enter Module Phone # on User Cellphone

Get the phone # of the installed SIM card in the module. Select “Enter Cell Module Phone” to add/edit the module phone number(s).

To enable a cellphone to control the module, touch “+” on “Enter Cell Module Phone #” page to add the module phone # to this cellphone unit.

Note: To control the module with a user cellphone, the module phone # must be set in the user cellphone.

2) Set Master User

Select the item and press “SEND” to set the phone as master user phone.

Note: When the module is shipped from manufacturer, the master user is blank. Any cellphone with module phone # entered can be set as master user by “Set Master User” command.

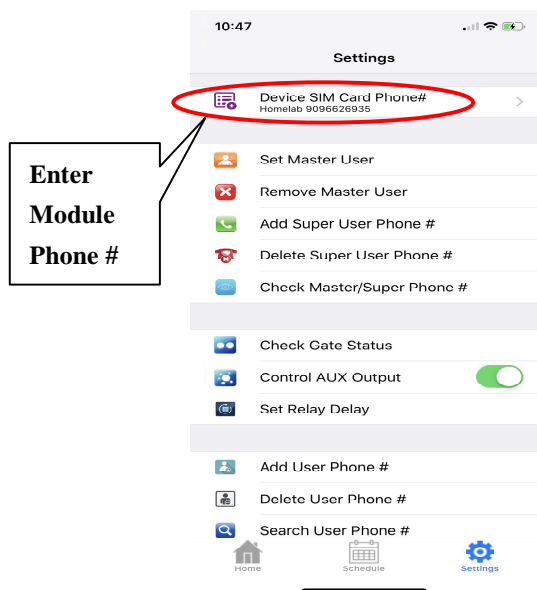

Enter Module Phone #

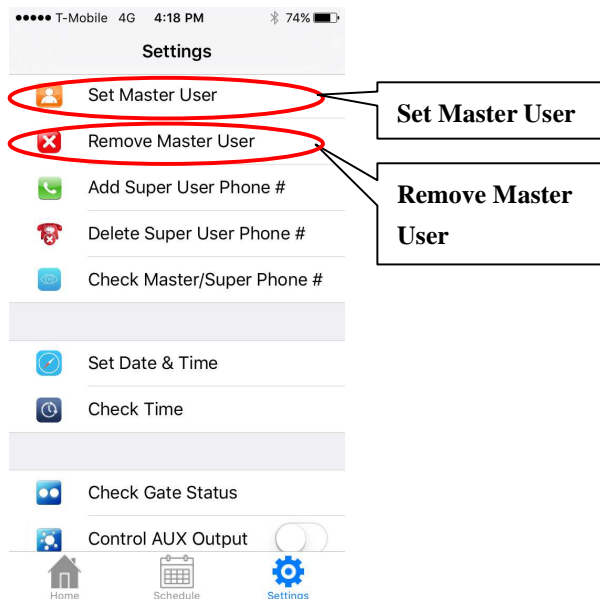

Set / Remove Master User

3) Remove Master User

Select “Remove Master User” and press “SEND” to remove the master user from the module.

Note:

- a. Master user can only be removed by master phone itself. When the master user is removed, any other phone can be set to master user of this module.
- b. **If the master user needs to be reset but the master phone is unavailable, call Platinum customer**

service and provide the module phone # and the new master phone #. The service technician will help switching to the new master user remotely.

4) Add and Delete Super User Phone #

Select the item and press “SEND”. Only master user can add and delete super users.

5) Check Master and Super Phone #

Select the item, enter super user phone # and press “SEND”. Only master and super users can check master / super user phone #.

6) Add User Phone #

Select the item, enter user phone #, user name and press “SEND”. Only master and super users can add user phone #.

7) Delete User Phone #

Select the item, enter user phone # and press “SEND”. Only master and super users can delete user phone #.

8) Check User Phone #

Select the item, enter the page number and press “SEND”. User phone numbers will be sent back in page (1-99). There are 12 phone numbers on each page. Only master and super users can check user phone #.

9) Search User Phone #

Select the item, enter the phone # to search and press “SEND”. This command is to verify whether the user phone # exists.

10) Set Date and Time

Select the item and press “SEND” to set module real time clock to current date and time.

11) Check Time

Select the item and press “SEND” to check date and time from module real time clock.

12) Check Gate Status

Select the item and press “SEND” to check current gate status (open/close/central). “Gate ST” terminals on module need to be wired to operator limit switches for reporting correct status.

13) Control AUX Output

Select the item, choose ON/OFF and press “SEND” to set the AUX contact output ON or OFF.

14) Set Relay Delay

Select the item and enter delay time (1-99 sec) to set control relay delay time.

15) Enable Cloud Connection

Select the item, press “SEND” to enable programming from cloud web site.

16) Remove Cloud Account

Select the item to remove current cloud user of this unit.

17) Service

Platinum customer service use only.

18) About

Select the item to check SW revision of the App.

GATE OPERATIONS

For users, on cellphone home page, use “**open**” icon to open the gate. For master and super users, use “**open**,” “**hold**” and “**release**” icons to control the gate. For all users, use “**log**” icon to check operation commands and acknowledgement messages.

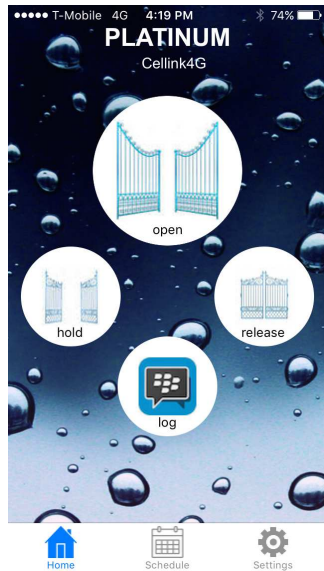

Home Page

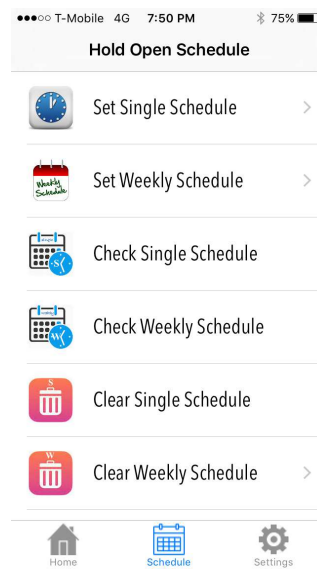

Hold Open Schedule

HOLD OPEN SCHEDULE OPERATIONS

The schedule functions are under App “**Schedules**” tab as shown above.

- 1) **Set Single Schedule**
Select the item, choose hold open period and press “SEND” to set single schedule.
- 2) **Set Weekly Schedule**
Select the item, choose hold open period/repeat weekday(s) and press “SEND” to set weekly schedule. Up to 5 weekly schedules can be set. If the weekly schedule memory is reported full, use “Clear Weekly Schedule” to free up the memory.
- 3) **Check Single Schedule**
Select the item and press “SEND” to check single schedule.
- 4) **Check Weekly Schedule**
Select the item and press “SEND” to check weekly schedule.
- 5) **Clear Single Schedule**
Select the item and press “SEND” to clear single schedule.
- 6) **Clear Weekly Schedule**

Select the item, choose the schedule ID number and press “SEND” to clear weekly schedule.

Note: There could be up to 5 weekly schedules in memory. Before clearing, use “Check Weekly Schedule” to review existing weekly schedule(s). Choose the right schedule(s) to clear. See the screen shots below.

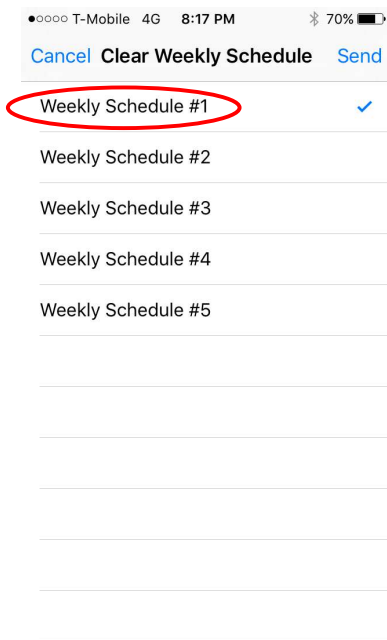

Weekly Schedule Report

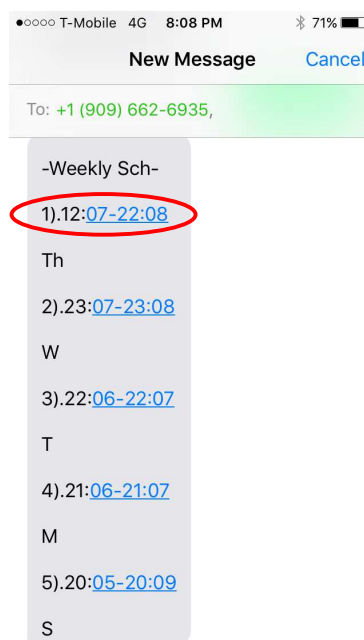

Clear Weekly Schedule Selection

CLOUD PROGRAMMING OPERATIONS

Phone number, hold open schedule, permission schedule and history log can be accessed remotely via Platinum cloud website. A reliable 4G LTE link is required to use this function.

1. Enable Unit Cloud Mode

The cloud access mode can only be enabled on smartphone App by master user.

On App setting menu, select “**Enable Cloud**” item to enable the cloud access to the unit.

2. Cloud Website

The cloud link “**Platinum Cloud Link**” is on the Platinum website (www.platinumasi.com) under “**Phones**” category. It can also be reached through the IP “**54.241.70.60/login.php**” with web browser on phone, pad, laptop or PC etc.

3. Account Register

On the login page, register an account with email address as user name. The registration is verified

through the email.

By following Amazon Web Service email verification process, the account registration steps are as below:

- a. Call Platinum customer service and request a Platinum cloud account registration.
- b. Provide your email address for customer service to add it in the user list.
- c. Once the request is processed, an email will be sent to your email address from Amazon Web Service for email verification.
- d. Click the link provided in the email to complete the verification.
- e. Then follow the web page below to click “Register” and follow the prompted steps to enter the AWS verified email address and set the password (at least one number, one uppercase letter, one lowercase letter and at least 8 or more characters).

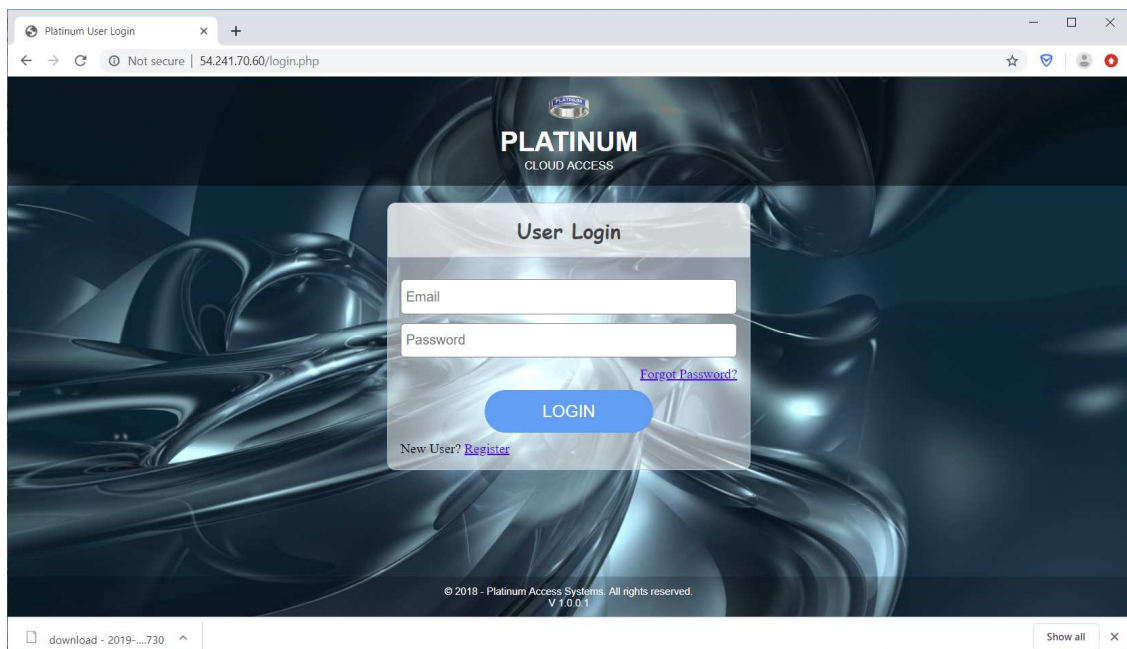

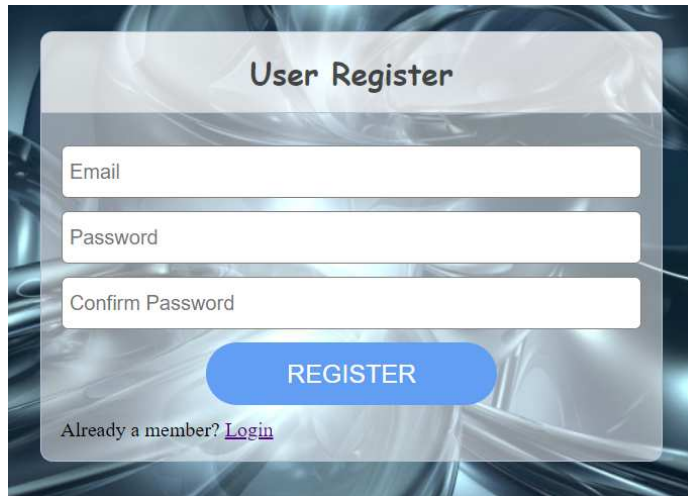
A screenshot of a 'User Register' form. The form has a title 'User Register' at the top. Below the title are three input fields: 'Email', 'Password', and 'Confirm Password'. A blue button labeled 'REGISTER' is positioned below the input fields. At the bottom left, there is a link that says 'Already a member? [Login](#)'.

- f. Click the “**REGISTER**” button, an email will be sent to the email address from “**Platinum Access Cloud**”.
- g. Open the email and click the link to complete the register process.
- h. Log in the cloud with the email and password.

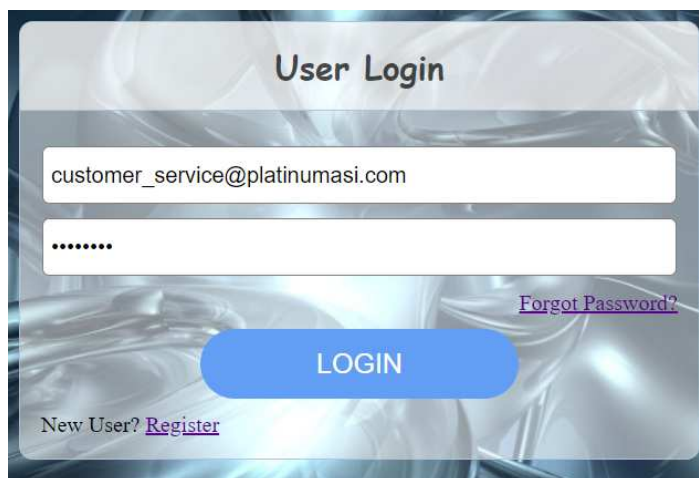
A screenshot of a 'User Login' form. The form has a title 'User Login' at the top. Below the title are two input fields: the first contains the email address 'customer_service@platinumasi.com' and the second contains a masked password '.....'. A blue button labeled 'LOGIN' is positioned below the input fields. To the right of the password field is a link that says '[Forgot Password?](#)'. At the bottom left, there is a link that says 'New User? [Register](#)'.

- i. If password is forgotten, click “Forgot Password” to reset the password.

4. Add Device

Once login, add the **Cellink4G+** unit with its SIM card phone number.

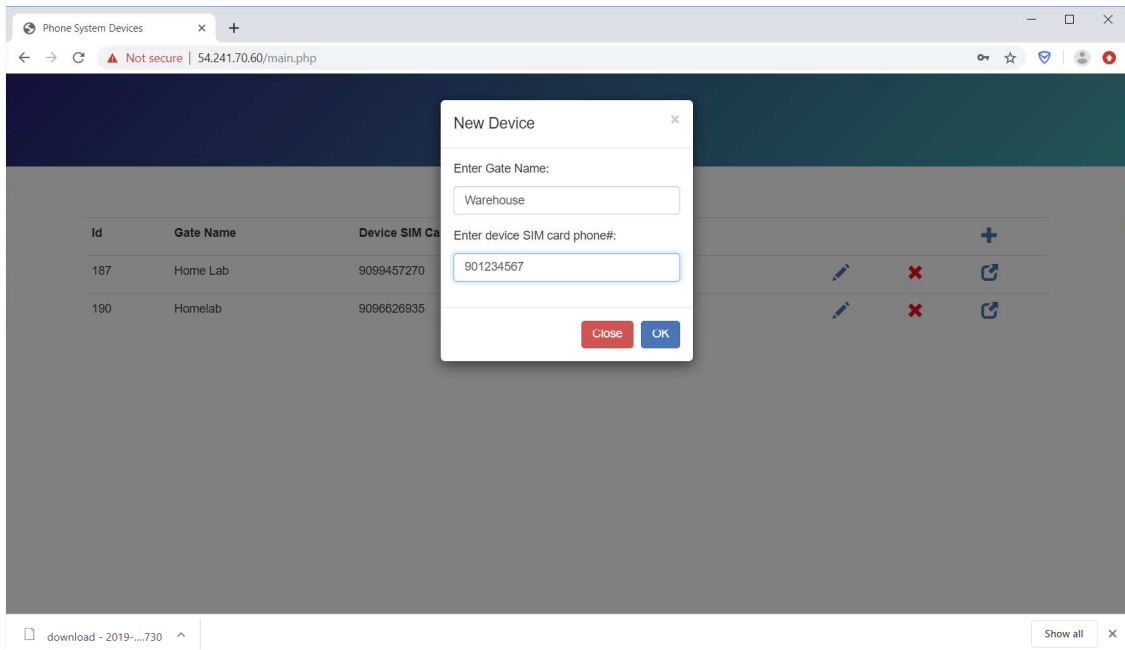

5. Connect Device

Use “**Enable Cloud**” command in “**MODULE CONFIGURATIONS**” section to enable device cloud access function.

On the device web page, click the link icon on this device to connect the **Cellink4G+** unit.

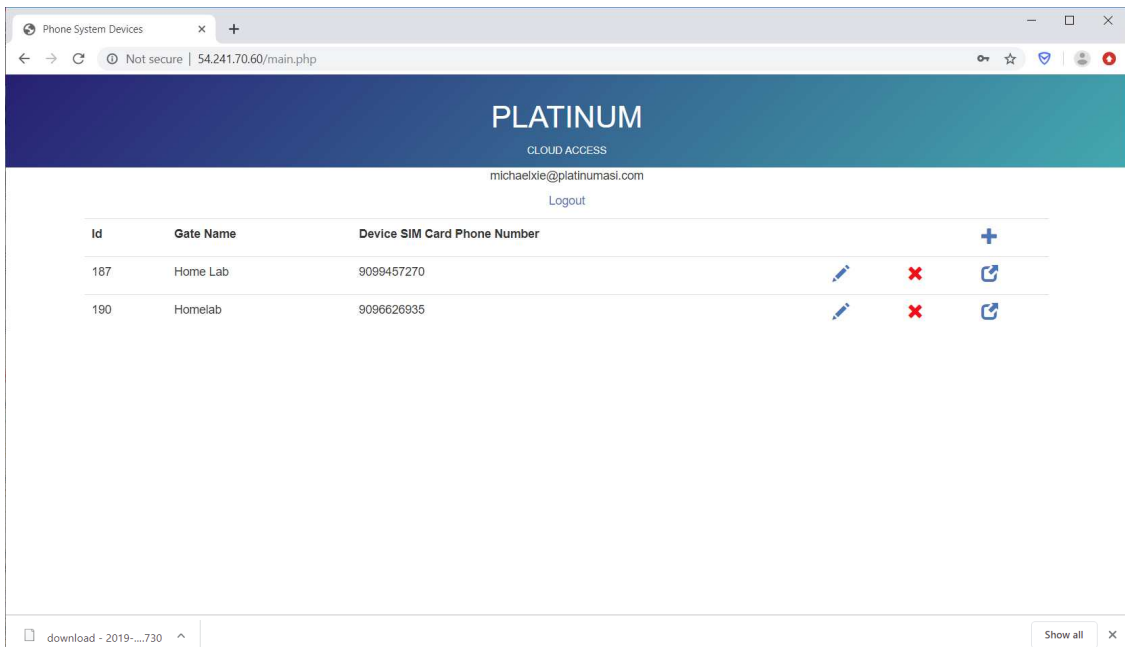

6. Access Programming Data

Once connected, phone number and hold open schedule data can be downloaded, updated and uploaded.

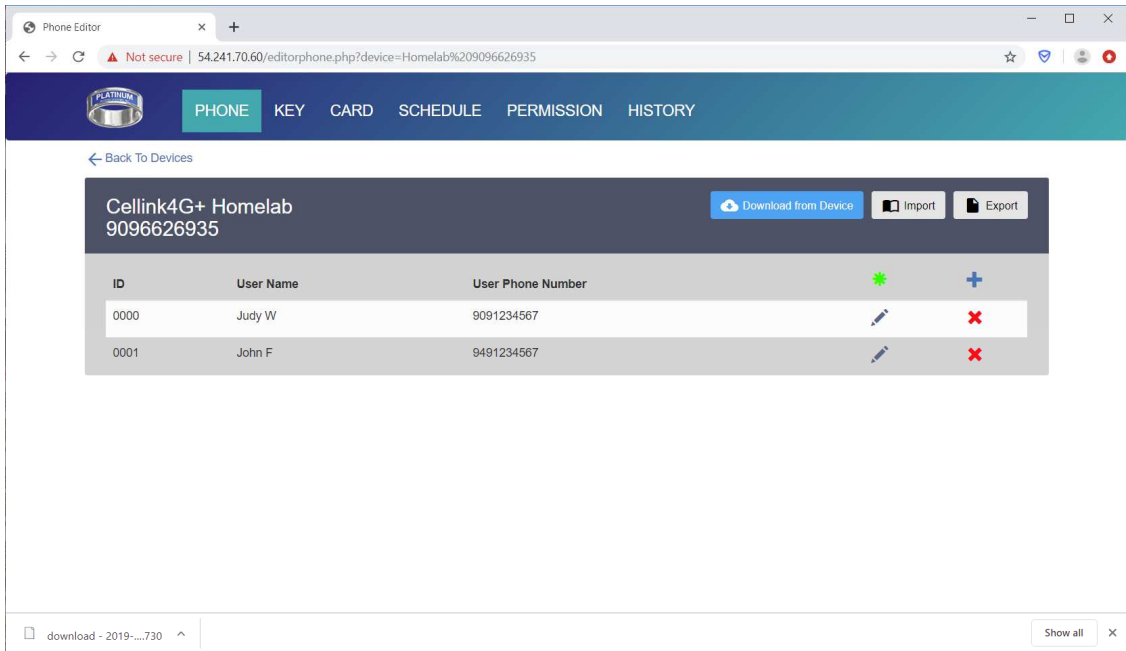

Note:

- The unit can be connected by only one account at a time. The account has to be removed from this unit for other account to connect.
- The cloud account for specific unit can be removed from “**Remove Cloud Account**” in smartphone App on master phone.
- Key and Card are not applied to **Cellink4G+** module.

7. Set Hold Open Schedule

6 hold open schedules (5 weekly and 1 single schedules) are available to set up.

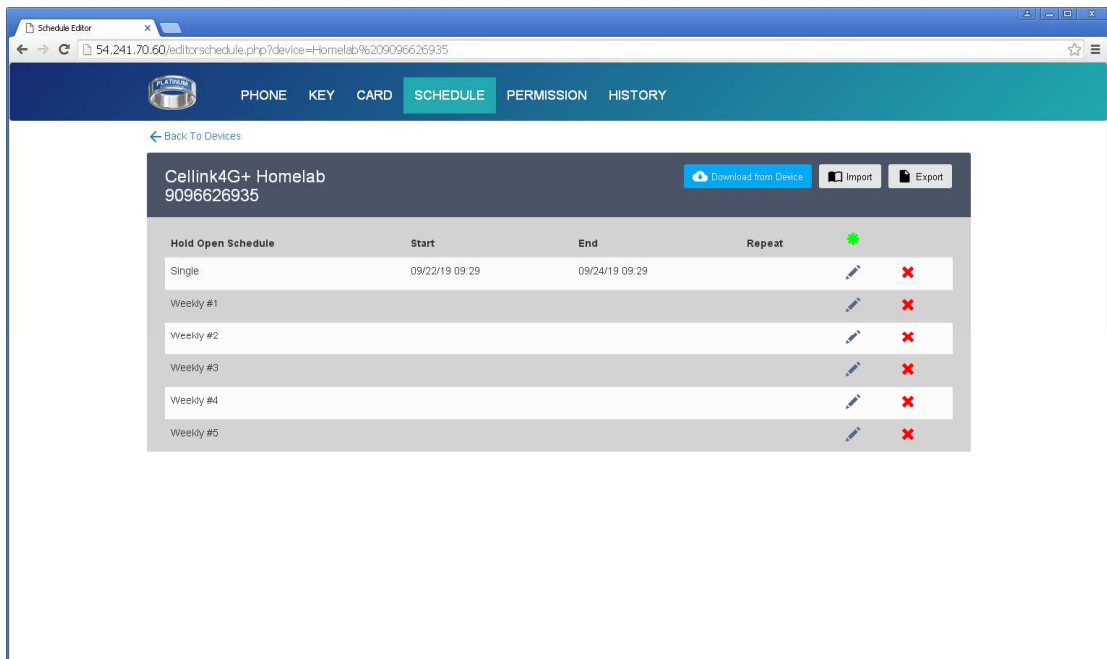

8. Set Permission Schedule

32 permission schedules (10 weekly and 22 single schedules) are available to set up. The schedule(s) can be assigned to each phone users. Only during the scheduled periods, the assigned phone users have the access capability to open the gate.

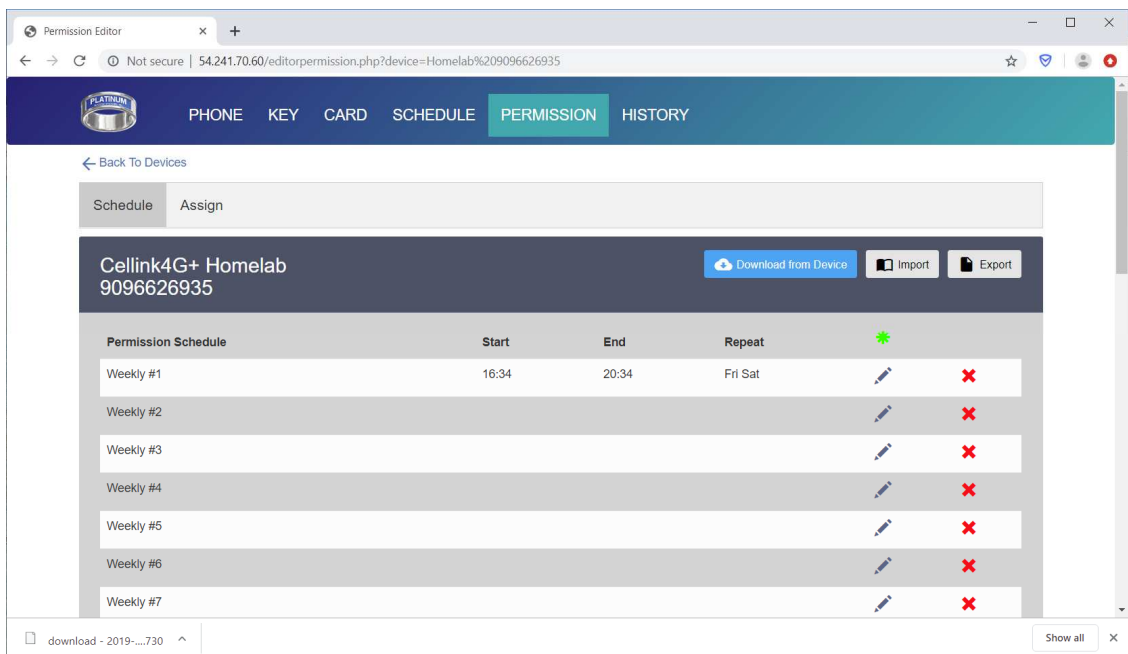

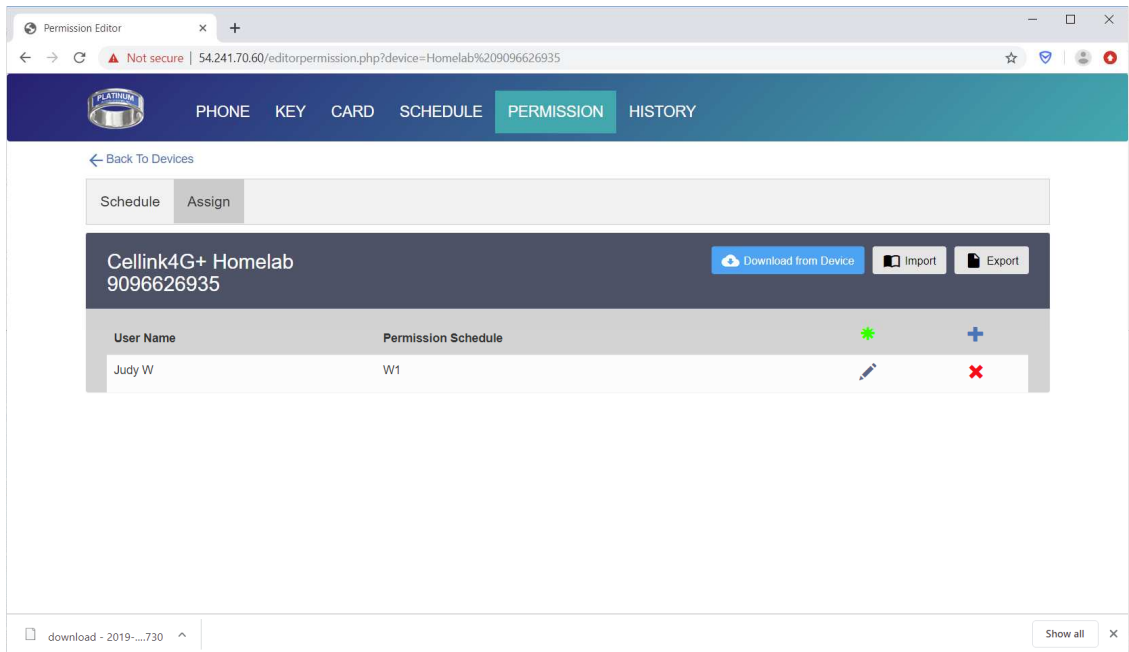

Note: Users without being assigned to any permission schedule are allowed to access the entry at any time.

9. Download History Log

Once connected, the history log can be downloaded as below.

